

HT 3525



FRONT WHEEL MOUNTING

# Crystalyte

europe

## Technical details

Motor type	Brushless direct drive
Output range	250 - 2000 Watt
Voltage range	24 - 72 Volt
Maximal Amp	45 Amp
RPM / V	6,5
Torque	40 - 90 Nm
Efficiency	86%
Weight	6,5 kg
Drop out	100 mm
Disc brake mounting	Yes
Freewheel mounting	n/a
Front or rear wheel	Front wheel
Controller type	Sensorless and sensed controllers

Magnet width	35 mm
Poles	23 pair
Hall sensors	3 x Honeywell
Bearings	NSK industrial
Sealings	Yes
Motor phase plug	3 x Anderson PP45
Hall sensor plug	Mini XLR 5 pin

### ALSO AVAILABLE WITH RIM & SPOKES

Spokes	SAPIM 12G INOX (size = 2,6 mm)
Rim	EXAL EX19 (24" - 29") / XL25 (20")
Rim sizes	20", 24", 26", 28" and 29er



AVAILABLE WITH RIM & SPOKES



HT 3525

ORDER ONLINE  
[www.crystalyte-europe.com](http://www.crystalyte-europe.com)



## Makes you want to drive electric

e-dr bvba • Hemelrijken 3a • 2890 Sint-Amands • Belgium • +32 (0)52 555 840 • info@crystalyte-europe.com

## Measurements

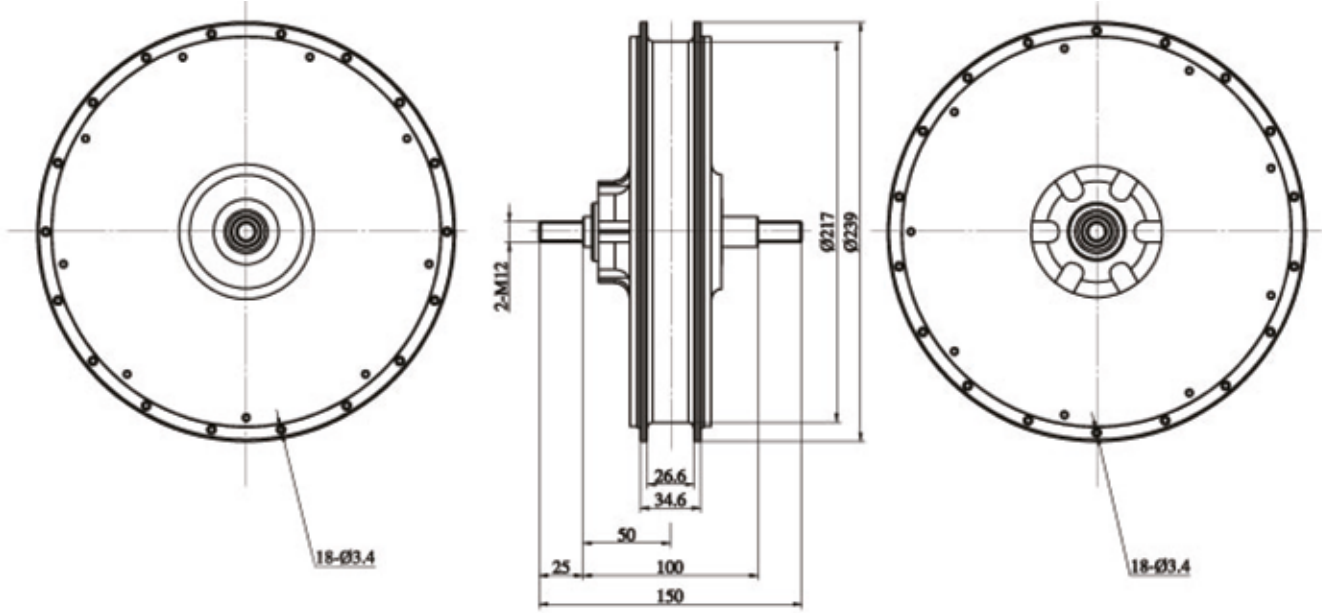

## Test results\*

Description	U (V)	I (A)	P1 (W)	M (N.m)	N (rpm)	P2 (W)	Eff (%)
Unload	35,94	0,918	33,00	0,04	250,0	1,04	3,1
Max-Eff	35,51	8,837	313,9	11,61	222,5	270,4	86,1
Max P-out	34,87	25,41	886,5	37,04	170,7	661,9	74,6
Max-Torque	34,87	26,53	925,3	60,16	46,1	290,3	31,3
End	34,87	26,53	925,3	60,16	46,1	290,3	31,3

\* Measured with 36V and 25 Amp controller

## Speed table

